

2
MEZZANINE PLAN
3/32" = 1'-0"

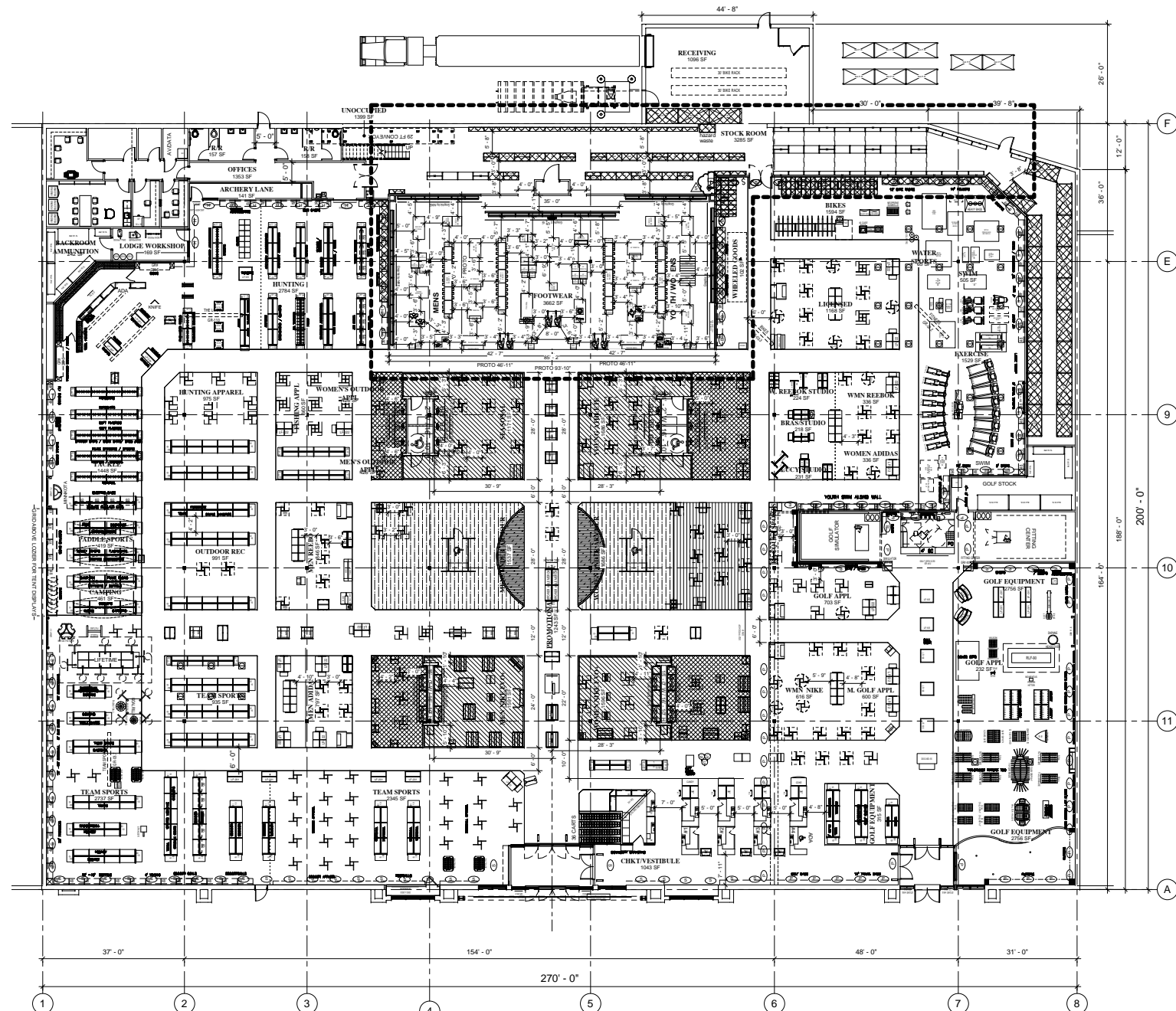

1
FSW RETROFIT-SPRING
3/32" = 1'-0"

FSFW FLOOR Fixture Tally				
Fixture Name	DESCRIPTION	SL Proto Count	Actual Count	Variance from Photo
MEN'S 1P FRONT PEDESTAL	DSG-NK-18FD-F	4	4	0
MEN'S 1P NETTING PEDESTAL	DSG-NK-18FD-N	2	2	0
MEN'S 2P PEDESTAL	DSG-NK-30FD	4	4	0
MEN'S 2P ACCESSORY FIXTURE	DSG-NK-30AF	2	2	0
MEN'S 3P PEDESTAL	DSG-NK-48FD	2	2	0
MEN'S 4P MANNEQUIN PLATFORM C	DSG-NK-PTFRM4C	1	1	0
MEN'S 4P MANNEQUIN PLATFORM D	DSG-NK-PTFRM4D	1	1	0
MEN'S 4P MANNEQUIN PLATFORM E	DSG-NK-PTFRM4E	1	1	0
MEN'S 4P PEDESTAL	DSG-NK-48FD	2	2	0
MEN'S FOOTWEAR BENCH	DSG-NK-FWBENCH-V2	2	2	0
MEN'S SOCK FIXTURE	DSG-NK-SKFIXT	1	1	0
MEN'S TRAINING TABLE BENCH	DSG-NK-TTBENCH	1	1	0
RUNNING 1P FRONT PEDESTAL	DSG-NK-18FD-F	6	6	0
RUNNING 1P NETTING PEDESTAL	DSG-NK-18FD-N	4	4	0
RUNNING 2P ACCESSORY TOWER	DSG-NK-24AT	3	3	0
RUNNING 2P PEDESTAL	DSG-NK-24FD	8	8	0
RUNNING 2P MANNEQUIN PLATFORM C	DSG-NK-PTFRM2C	1	1	0
RUNNING EQUIPMENT CENTER	DSG-NK-REC-V2	1	1	0
RUNNING FOOTWEAR BENCH	DSG-NK-FWBENCH-V2	1	1	0
RUNNING FOOTWEAR BENCH ADA	DSG-NK-FWBENCH-ADA	1	1	0
RUNNING TREADMILL	DSG-NK-TREADMILL	1	1	0
RUNNING TREADMILL COMMUNITY BIROLD	DSG-NK-TM	1	1	0
WOMEN'S 2P ACCESSORY FIXTURE	DSG-NK-30AF	2	2	0
WOMEN'S 2P PEDESTAL	DSG-NK-30FD	2	2	0
WOMEN'S 4P MANNEQUIN PLATFORM A	DSG-NK-PTFRM4A	1	1	0
WOMEN'S 4P MANNEQUIN PLATFORM B	DSG-NK-PTFRM4B	1	1	0
WOMEN'S 4P MANNEQUIN PLATFORM C	DSG-NK-PTFRM4C	1	1	0
WOMEN'S 4P PEDESTAL	DSG-NK-48FD	2	2	0
WOMEN'S BLEACHER TABLE	DSG-NK-TB	2	2	0
WOMEN'S FOOTWEAR BENCH	DSG-NK-FWBENCH-V2	2	2	0
WOMEN'S TRAINING TABLE BENCH	DSG-NK-TTBENCH	1	1	0
Grand total		64	64	0

FSFW WALL Fixture Tally				
Fixture Name	DESCRIPTION	SL Proto Count	Actual Count	Variance from Photo
WALL 12 ACCESSORY	DSG-NK-EWP12	1	1	0
WALL LIGHT BOX	DSG-NK-LB	1	1	0
WALL PANEL - MEN'S	DSG-NK-4PWWP	20	20	0
WALL PANEL - WOMEN'S	DSG-NK-4PWWP	18	17	-1
Grand total		40	39	-1

FSFW Gondola Length				
Gender	Proto Linear FT	Actual Linear FT	Variance Linear FT	Variance Linear FT
FSFW MEN'S GONDOLA	70'-0"	70'-0"	0'-0"	0'-0"
FSFW WOMEN'S GONDOLA	70'-0"	70'-0"	0'-0"	0'-0"
Grand total	140'-0"	140'-0"	0'-0"	0'-0"

SHOEBOX CAPACITY (BOXES)				
PROTO	EXISTING	ACTUAL	VARIANCE	VARIANCE
	15,000	12,038	15,100	+100
				+3,062

STORAGE CAPACITY (CU. FT.)				
	EXISTING	ACTUAL	VARIANCE	VARIANCE
FOOTWEAR	UNKNOWN	2211 new	0	0
RECEIVING	UNKNOWN	0	0	0
MAIN	UNKNOWN	0	0	0

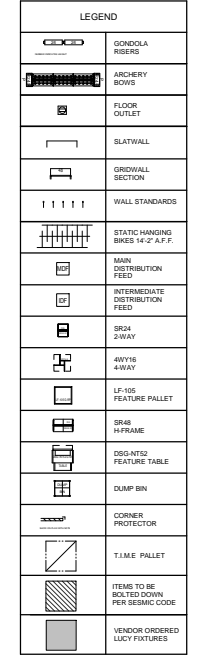
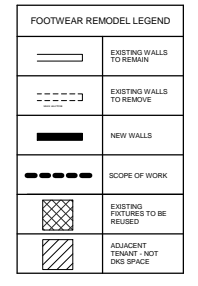

PROJECT SCOPE

- Reuse existing side walls
- Reuse portion of rear wall
- Reuse existing lighting as much as possible
- Replace flooring
- Repurpose existing footwear stock racks for footwear and/or add new as required to accommodate added capacity

WAVE: 1 BUCKET: 1A

DISCLAIMER: ARCHITECT MUST REVIEW THE ENTIRE FLOOR PLAN FOR ANY ARCHITECTURAL CHANGES. DGS HAS MADE ALL ATTEMPTS TO CLEARLY CLOUD ALL CHANGES, BUT THE ARCHITECT IS RESPONSIBLE FOR ALL ARCHITECTURAL CHANGES, CLOUDS OR NOT.

Revisions			
REV	BY	DATE	DESCRIPTION
1	SK	12/23/15	See footwear dock
2	SK	1/23/16	See footwear dock
3	SK	1/23/16	See footwear dock
4	SK	2/1/16	See footwear dock
5	SK	2/1/16	See footwear dock
6	SK	2/1/16	See footwear dock
7	SK	2/1/16	See footwear dock
8	SK	2/1/16	See footwear dock
9	SK	2/1/16	See footwear dock
10	SK	2/1/16	See footwear dock
11	SK	2/1/16	See footwear dock
12	SK	2/1/16	See footwear dock
13	SK	2/1/16	See footwear dock
14	SK	2/1/16	See footwear dock
15	SK	2/1/16	See footwear dock
16	SK	2/1/16	See footwear dock
17	SK	2/1/16	See footwear dock
18	SK	2/1/16	See footwear dock
19	SK	2/1/16	See footwear dock
20	SK	2/1/16	See footwear dock
21	SK	2/1/16	See footwear dock
22	SK	2/1/16	See footwear dock
23	SK	2/1/16	See footwear dock
24	SK	2/1/16	See footwear dock
25	SK	2/1/16	See footwear dock
26	SK	2/1/16	See footwear dock
27	SK	2/1/16	See footwear dock
28	SK	2/1/16	See footwear dock
29	SK	2/1/16	See footwear dock
30	SK	2/1/16	See footwear dock
31	SK	2/1/16	See footwear dock
32	SK	2/1/16	See footwear dock
33	SK	2/1/16	See footwear dock
34	SK	2/1/16	See footwear dock
35	SK	2/1/16	See footwear dock
36	SK	2/1/16	See footwear dock
37	SK	2/1/16	See footwear dock
38	SK	2/1/16	See footwear dock
39	SK	2/1/16	See footwear dock
40	SK	2/1/16	See footwear dock
41	SK	2/1/16	See footwear dock
42	SK	2/1/16	See footwear dock
43	SK	2/1/16	See footwear dock
44	SK	2/1/16	See footwear dock
45	SK	2/1/16	See footwear dock
46	SK	2/1/16	See footwear dock
47	SK	2/1/16	See footwear dock
48	SK	2/1/16	See footwear dock
49	SK	2/1/16	See footwear dock
50	SK	2/1/16	See footwear dock
51	SK	2/1/16	See footwear dock
52	SK	2/1/16	See footwear dock
53	SK	2/1/16	See footwear dock
54	SK	2/1/16	See footwear dock
55	SK	2/1/16	See footwear dock
56	SK	2/1/16	See footwear dock
57	SK	2/1/16	See footwear dock
58	SK	2/1/16	See footwear dock
59	SK	2/1/16	See footwear dock
60	SK	2/1/16	See footwear dock
61	SK	2/1/16	See footwear dock
62	SK	2/1/16	See footwear dock
63	SK	2/1/16	See footwear dock
64	SK	2/1/16	See footwear dock
65	SK	2/1/16	See footwear dock
66	SK	2/1/16	See footwear dock
67	SK	2/1/16	See footwear dock
68	SK	2/1/16	See footwear dock
69	SK	2/1/16	See footwear dock
70	SK	2/1/16	See footwear dock
71	SK	2/1/16	See footwear dock
72	SK	2/1/16	See footwear dock
73	SK	2/1/16	See footwear dock
74	SK	2/1/16	See footwear dock
75	SK	2/1/16	See footwear dock
76	SK	2/1/16	See footwear dock
77	SK	2/1/16	See footwear dock
78	SK	2/1/16	See footwear dock
79	SK	2/1/16	See footwear dock
80	SK	2/1/16	See footwear dock
81	SK	2/1/16	See footwear dock
82	SK	2/1/16	See footwear dock
83	SK	2/1/16	See footwear dock
84	SK	2/1/16	See footwear dock
85	SK	2/1/16	See footwear dock
86	SK	2/1/16	See footwear dock
87	SK	2/1/16	See footwear dock
88	SK	2/1/16	See footwear dock
89	SK	2/1/16	See footwear dock
90	SK	2/1/16	See footwear dock
91	SK	2/1/16	See footwear dock
92	SK	2/1/16	See footwear dock
93	SK	2/1/16	See footwear dock
94	SK	2/1/16	See footwear dock
95	SK	2/1/16	See footwear dock
96	SK	2/1/16	See footwear dock
97	SK	2/1/16	See footwear dock
98	SK	2/1/16	See footwear dock
99	SK	2/1/16	See footwear dock
100	SK	2/1/16	See footwear dock

DICK'S SPORTING GOODS

SPORTING GOODS

DICK'S SPORTING GOODS
#380
GREEN BAY
ASHWAUBENON, WI

FSW RETROFIT - SPRING

DATE: 01/26/16
SCALE: As indicated
DRAWN BY: JSD

F-1

S:\cadd\active projects\2016 Projects\Special Projects\Footwear\Wave 1\380 Green Bay, WI\current\021016 - 380 - Green Bay WI.rvt
2/10/2016 1:34:08 PM